

| Order Code | See Notes | Item                                 |
|------------|-----------|--------------------------------------|
| ML2CB      | 1         | MULTiLOG2 Control box & PC software  |
| MLS20      | 2         | Air temperature sensors (20m)        |
| MLD20      | 3         | Digital Sensor door switch           |
| ML2Dext    |           | Digital sensor extension lead (100m) |
| MLE100     | 4         | Temperature extension lead (100m)    |
| ML2JCT     | 6         | Junction box                         |
| ML2INSK    | 7         | MULTiLOG2 Installation Kit           |
| ML2WALL    | 5         | USB mains wall charger               |
| ML2BATT    |           | MULTiLOG2 batteries (2 required)     |
|            | 8         | Contract SIM card - NOT SUPPLIED     |

| Notes: |  |   |
|--------|--|---|
| 1      | ML2CB includes:  |   |
|        |  | <ul style="list-style-type: none"> <li>• LCD display and battery indicator &amp; 2 batteries (recharged from the USB)</li> <li>• GSM/GPRS autodialler (requires a user programmed SIM card and a 'Roaming' cell-phone contract)</li> <li>• Internal alarm sounder , USB Cable connector to PC (2m)</li> </ul> |
| 2      | Air temperature sensor cable (20m as standard),  |   |
| 3      | Digital sensors monitor door state (open/shut)   |   |
| 4      | Temperature sensor extension lead used to extend the 20m sensor cable up to a maximum sensor lead distance of 200m from the MULTiLOG2 control box. |   |
| 5      | USB mains wall charger allows the MULTiLOG2 to be powered without a PC (not recommended)   |   |
| 6      | Junction box for joining extension cable to sensor cable   |   |
| 7      | Installation Kit, tools, cable ties & clips, craft knife, 500ml expandable foam, digital thermometer, carrying bag                                 |   |
| 8      | Contract SIM card required for the GSM/GPRS modem for SMS messaging (Vodafone™ partner Service Provider recommended)                               |   |

**A typical order might be**

| Order code | Quantity | Item   |
|------------|----------|--|
| ML2CB      | 1        | MULTiLOG2 control box (ML2) & Software ML2SOFT |
| MLS20      | 16       | Air temperature sensors                        |
| MLE100     | 2        | Temperature extension lead (100)               |
| ML2INSK    | 1        | MULTiLOG2 Installation Kit                     |
| ML2JCT     | 4        | Junction box                                   |

## MULTiLOG2 Sensors

Air temperature sensor cable (20m as standard),  
MLS20



Digital sensors monitor door state (open/shut)  
MLD20



Temperature sensor extension lead used to extend the 20m sensor cable up to a maximum sensor lead distance of 200m from the MULTiLOG2 control box.

100m temperature  
extension cable

MLE100



100m digital  
extension cable

ML2Dext

Junction box

ML2JCT



## MULTiLOG2 Installation Kit

ML2INSK

Carry bag (40x25x10cm) containing;

- Digital thermometer,
- Tool kit,
- 500ml expandable foam
- Craft knife.
- Cable ties and clips,



### MULTiLOG2 Miscellaneous

USB Mains wall charger

ML2WALL

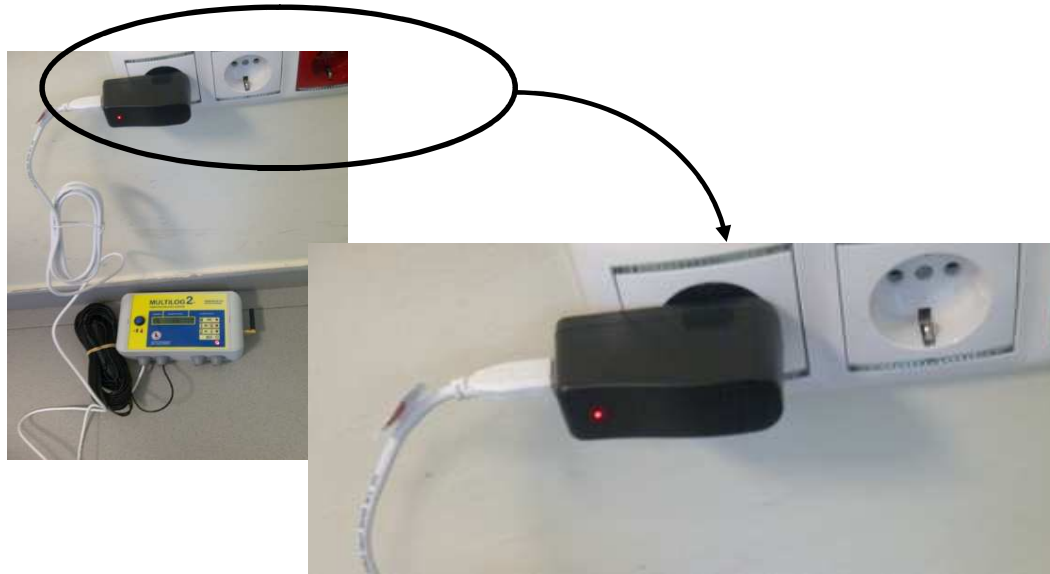

PC Software

Batteries  
x 2

ML2BATT



4.8V 2600mAh square battery pack  
**Futaba connector (male)**